



User guide for *Condiment Bottle Holder Deluxe 500 and 1000 products*

Congratulations on Your purchase of Dunlin's *Condiment Bottle Holder (CBH) Deluxe* product! It is our sincere hope that owning this product will live up to Your high standards on all counts including aesthetic pleasure, ease of use, durability, and compatibility.

We know You work hard and appreciate elegance so we are pleased to have earned Your trust to let us elevate Your life experiences with the help of this luxurious product!

Please reach out to us for additional product purchases, and for providing any feedback or ideas on our website at www.mydunlin.com. Please consider recommending this product to others as well.



Thank You
The Dunlin Corporation Team, at Your service

Introduction

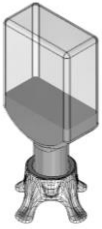

Thank you for purchasing the *Condiment Bottle Holder Deluxe* product from Dunlin Corporation. This product enables you to keep a great variety of condiment bottles that have little content left cap-side down in a stable manner. This enables the leftover contents of the bottle to accumulate near the cap making it easy and immediately possible to access them when you want them and where you want them. Once the bottle is inserted into the product its contents will accumulate near the bottle without additional shaking or slapping.

The product can be used in numerous application areas including supporting condiment bottles in the fridge, pantry, on the dining table for serving condiments during dinner, on the kitchen counter to access condiments for cooking, on the grilling bench for outdoor cooking, during camping or RV use, etc. While the product is called *Condiment Bottle Holder*, its use is not restricted to condiment bottles. Honey, syrups, and even certain household cleaning materials use compatible bottles.

Several condiment bottles are sold with the cap already facing down. The *Condiment Bottle Holder Deluxe* is not meant to be used for such bottles. The product is also not intended to be used with bottles that contain high liquidity substances such as hot sauces, soy sauces, or other marinating liquids as these can be easily and immediately accessed when the bottle is turned upside down. The product is also not compatible with bottles equipped with a dispenser pump head.



The *Condiment Bottle Holder Deluxe* is made of high-quality engineering plastic [1] and durable stainless steel [2] parts. It resists not only common chemicals in the kitchen (cleaning agents, acidic or basic food items) but also a moderate amount of mechanical impact (it will not break if dropped or stepped on). The custom, organic shape is a result of surface modeling design techniques also used in the automotive industry. Thanks to the high quality of the product it shall serve its function for a lifetime and beyond as it was designed to serve you as long as you wish to use it.

Overview of the *Condiment Bottle Holder Deluxe* product

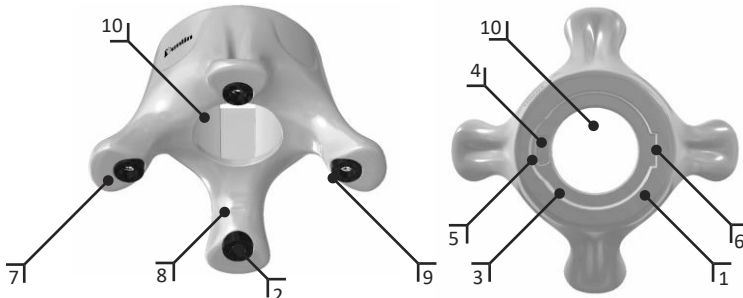

- [1] – Condiment Bottle Holder body
- [2] – Stainless steel screw (Quantity 4)
- [3] – Cavity for cap/bottle
- [4] – Model indicator (500 or 1000)
- [5] – Lip groove
- [6] – Hinge groove
- [7] – Leg (Quantity 4)
- [8] – Stacking recess (Quantity 4)
- [9] – Anti-slip rubber bumper (Quantity 4)
- [10] – Push-hole

Inserting a bottle into the product



Use the product when the contents of the condiment bottle become difficult to extract without keeping it cap-side down. This normally means the bottle should be less than half full. Many condiments are relatively easy to extract until the bottle reaches the last quarter of its contents.

In order to insert the bottle cap-side down into the product, the bottle must be sealed with its cap to avoid leaks. Make sure the cap is tightly attached to the bottle. Most caps are twisted on so assure they are twisted on tightly.

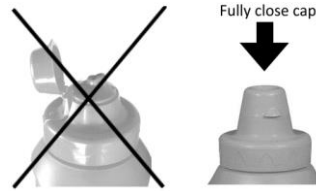
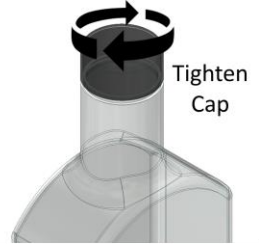

Hinged caps should be fully closed which is often indicated by a popping sound during the closing of the cap. Keeping the cap clean before inserting also helps with the fit. Do not insert a bottle without a cap or with an open cap as it will result in the leaking of contents.

Turn the bottle cap-side down and insert the cap into the cavity [3] of the product. Let the bottle sit by its own weight inside the product. If the fit is tight, apply gentle pressure to reach a stable connection. If the fit is slightly loose let the bottle lean and assure that the bottle does not tip over when left alone.

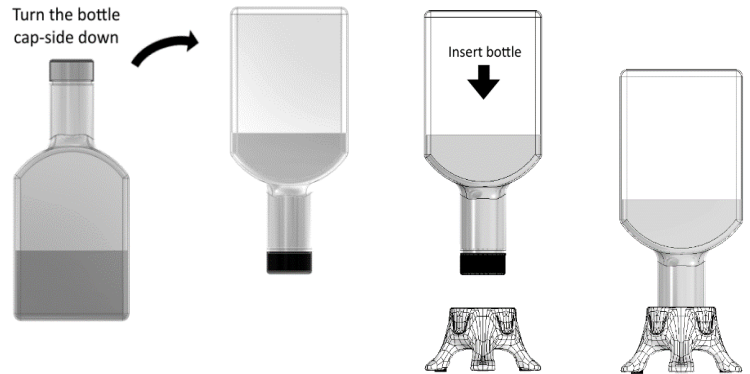

Depending on the shape of the bottle and cap the cap may not reach the bottom of the cavity which is fine (a gap is OK). If the fit is very loose, the bottle may not be compatible with the holder. Please note that there are two versions of the product CBH Deluxe 500 and CBH Deluxe 1000 [4]. The 500 was designed for smaller caps than the 1000 product.

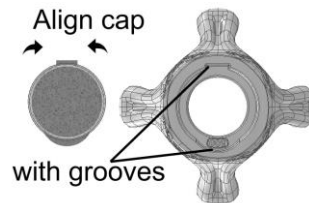
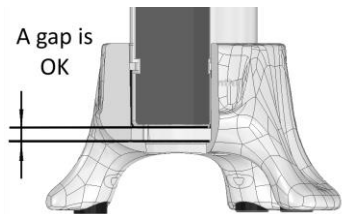

The *Condiment Bottle Holder Deluxe* has a specially designed shape that allows caps with hinges and/or lips (if any) to fit. Make sure to align the cap with the hinge [6] and/or lip [5] grooves when inserting the bottle into the product.

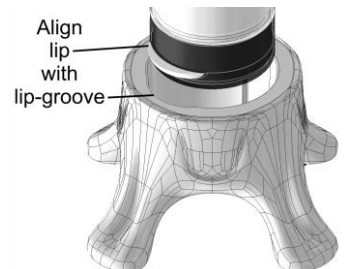
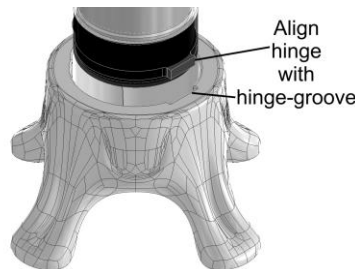

Storing a bottle in the product

The product has four legs [7] for increased stability, however, when used in the fridge door, care should be taken during the opening and closing of the fridge door to avoid sudden movements as they may cause loss of balance and eventually tipping over of the bottle. To reduce the chances of such occurrences, use the product only when the bottle is less than half full.

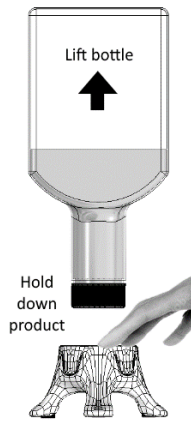

If a bottle is tightly sitting in the product and is equipped with a screw-on cap either (a) hold on to the product with one hand and use the other hand to pull the bottle out or (b) hold down the product against a stable surface with one hand and use the other hand to pull the bottle out.

The legs are tall to enable horizontal stacking of the products which results in space maximization. Simply position the product's leg under the other product to maximize space utilization.

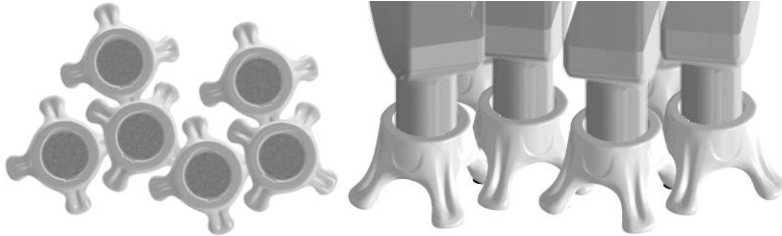

Cleaning the product

It is recommended to clean the product to sustain an aesthetically pleasing look and to avoid clogging the [3] cavity. For effective and easy cleaning use dish wash liquid with warm water and a scratch-free sponge. The product can be either hand-washed or cleaned in a dishwasher machine. For removing excessive deposits, soak the product in warm, soapy water to loosen up the deposits then proceed with the sponge or dishwasher.



Depending on the storage surfaces the [9] rubber bumpers may get dirty which reduces their slip resistance. If this phenomenon is experienced, consider focusing the cleaning to the bumpers only with the methods described above.



The product can be stacked vertically for storage by aligning the stacking recesses [8] with the top of another product.

The legs end in rubber bumpers [9] that prevent slipping and scratching on smooth, sensitive surfaces.

The product can be stored in the fridge and/or freezer if needed for any period of time.



Handling precautions

The following handling precautions should be followed to prolong the life of the product.

Moving a bottle with the product

Hold both the product and the bottle simultaneously when moving them to avoid accidental separation of the two.

Removing a bottle from the product

In order to access the contents of the bottle, simply remove the bottle from the product, open the cap, and dispense the contents.



If a bottle is loosely sitting in the product, simply lift the bottle out of the product.

If a bottle is tightly sitting in the product and is equipped with a hinged cap, either (a) hold on to the product with one hand and use the other hand's finger to push the bottle out through the push-hole [10] or (b) hold down the product against a stable surface with one hand and use the other hand's finger to push the bottle out through the push-hole. These operations will assure that the hinged cap does not open during the removal of the bottle.

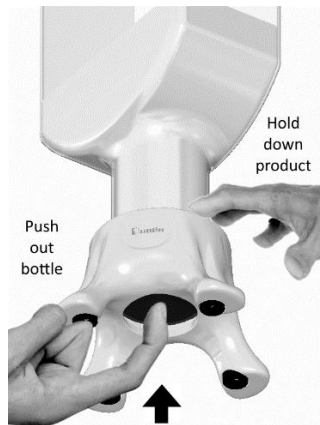

Do not microwave it as it contains metal parts.	Do NOT MICROWAVE
Avoid direct, prolonged exposure to the sun to avoid discoloration.	UV
Do not remove any parts of the product as they are essential for the intended functions.	
In the unlikely case of the screws coming loose, tighten them with a #1 Phillips screwdriver.	
Do not throw the product into the fire as the fumes may be harmful.	
Reuse or recycle the packaging box.	CORRUGATED RECYCLES
If disposed of, please throw the product into the recycle bin instead of regular trash.	PLEASE RECYCLE